

| SHAFT NO. | SIZE | SHAFT NAME | LOCATION | DOOR MKD. | SIZE |
|-----------|-------------|------------------------------|-------------------------|-----------|-------------|
| SH1 | 1.25 X 2.4 | West Lobby | West Lobby | D1 | 2.4 X 2.4 |
| SH2 | 0.65 X 1.05 | Pressurized FF Shaft | West Lobby | D2 | 1.2 X 2.4 |
| SH3 | 0.65 X 2.0 | Electrical Shaft | West Lobby | D3 | 0.77 X 2.4 |
| SH4 | 0.65 X 1.2 | MV Shaft | East Lobby | SD1 | 0.945 X 2.4 |
| SH5 | 0.65 X 0.6 | Pressurized LV Shaft | East Lobby | SD2 | 0.75 X 2.4 |
| SH6 | 0.65 X 1.05 | FHC Shaft | East Lobby | SD3 | 1.7 X 2.4 |
| SH7 | 0.6 X 2.65 | Stair corridor exhaust Shaft | West Staircase | SD4 | 0.9 X 2.4 |
| SH8 | 0.6 X 4.7 | Stair corridor exhaust Shaft | East Staircase | SD5 | 1.0 X 2.4 |
| SH9 | 1.825 X 0.4 | Duct | Staircase central shaft | D4 | 3.0 X 2.4 |
| SH10 | 1.66 X 0.8 | Staircase central shaft | Staircase central shaft | D5 | 2.25 X 2.4 |
| SH11 | 0.8 X 0.775 | For Exhaust Air Duct | Staircase central shaft | D6 | 0.9 X 2.4 |
| SH12 | 1.3 X 0.4 | Toilet Exhaust Air Duct | | | |

Certificate Of Building Plan

I/We do hereby certify that plans, elevations and sections and other structural details of the proposed building on Plot No.- A1-3, Block - GP, Sector - V, Kolkata-700091, under the jurisdiction of Industrial Township Authority have been personally inspected and so designed by me/us with such foundation and super structure safe in all respect including the consideration of bearing capacity and settlement of soil and other conditions, if any conforming to all stipulations of all relevant is Code of Practice and National Building Code.

Signature Of Architect
Dhruvrajyoti Saha
Reg. No.-CA/2005/35277

Certificate Of Structural Stability

I/We hereby certify that the foundation and superstructure of the building proposed for construction on Plot No.- A1-3, Block - GP, Sector - V, Kolkata-700091, under the jurisdiction of Industrial Township Authority have been personally inspected and so designed by me/us with such foundation and super structure safe in all respect including the consideration of bearing capacity and settlement of soil and other conditions, if any conforming to all stipulations of all relevant is Code of Practice and National Building Code.

Signature Of Structural Engineer
Sanjay J. Parash

Signature Of Geo-Technical Engineer
Jishnu Pal
Reg. No.-E.S.E./1104

Certificate Of Structural Reviewer

I/We hereby certify that the building site proposed for construction at Plot No.- A1-3, Block - GP, Sector - V, Kolkata-700091, under the jurisdiction of Industrial Township Authority has been visited by me/us and all the designs, drawing(s) specify the drawing number serially, Soil Test Report and Load Test Report for foundation and superstructure have been duly reviewed conforming to stipulations of all latest relevant IS Code of practice and National Building Code and it is found that everything is completely in order and the proposed foundation and super structure are safe in all respect.

Signature Of Structural Reviewer
Sanjay Guha
Reg. No.-E.S.R./188/16

Certificate Of Owner

Certified that I shall not on a later date, make any addition or alteration to this plan so as to convert it for my use or allow it to be used for separate offices/shops/storeroom. Certified that I have gone through the Building Rules for Industrial Township Authority & also undertake to abide by those rules during & after construction of building. Certified that I also undertake to report of commencement before seven days and completion would be reported within 30 days. I also undertake to report that there is no court case or any complaints from any corner in respect of my property as per plan. Industrial Township Authority will not be liable for any type of dispute if arises in future further there is no tenant in the above said premises.

Signature Of Applicant/Owner
MIS DELTA PV PRIVATE LIMITED
ADDRESS - A1-3, BLOCK-GP, SECTOR - V, SALT LAKE CITY, KOLKATA - 700091

Project:

ADDITION & ALTERATION PLAN OF DOUBLE BASEMENT+GROUND+IV NOS. PODIUM + XVIII STORIED INFORMATION TECHNOLOGY OFFICE BUILDING OF MIS DELTA PV PRIVATE LIMITED AT SALTLEC ELECTRONICS COMPLEX, PLOT NO.-A1-3, BLOCK - GP, SECTOR - V, SALT LAKE, KOLKATA-91, P.S.- BIDHANNAGAR, DIST. - 24 PARGANAS(N).
SITE COORDINATES-88 25 57 10-22 34 14.50, 88 25 57 80-22 34 16.00, 88 25 58 02-22 34 13.50, 88 26 00 28 20 10-22 34 14.90
WEST BENGAL FIRE & EMERGENCY SERVICES
NABADIGANTA INDUSTRIAL TOWNSHIP AUTHORITY
Previous Sanctioned AN No.-INDWB/FES/2019/2020/74114 Dated:- 14/02/2020
Previous Sanctioned AN No.-019146201100400 Dated:- 03/03/2021

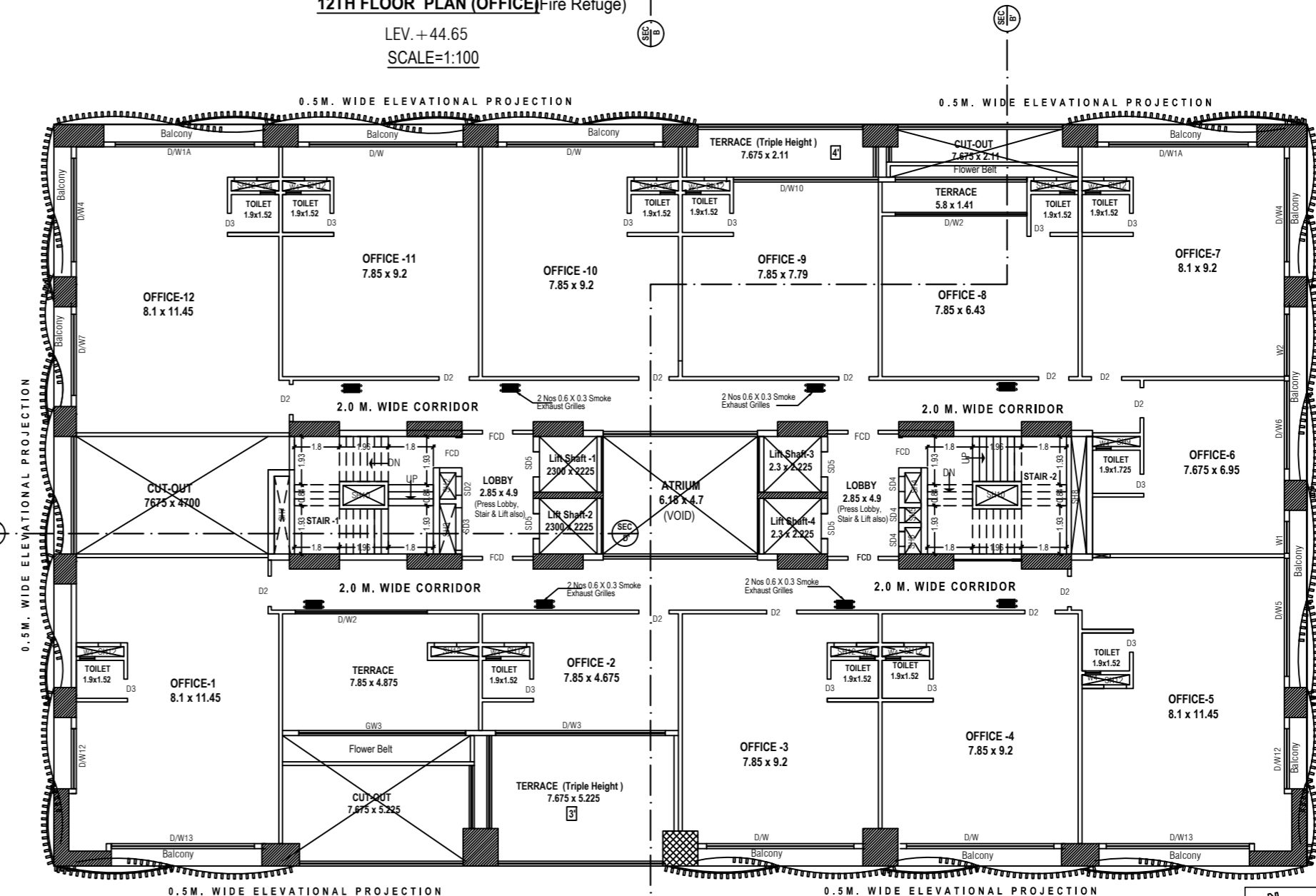
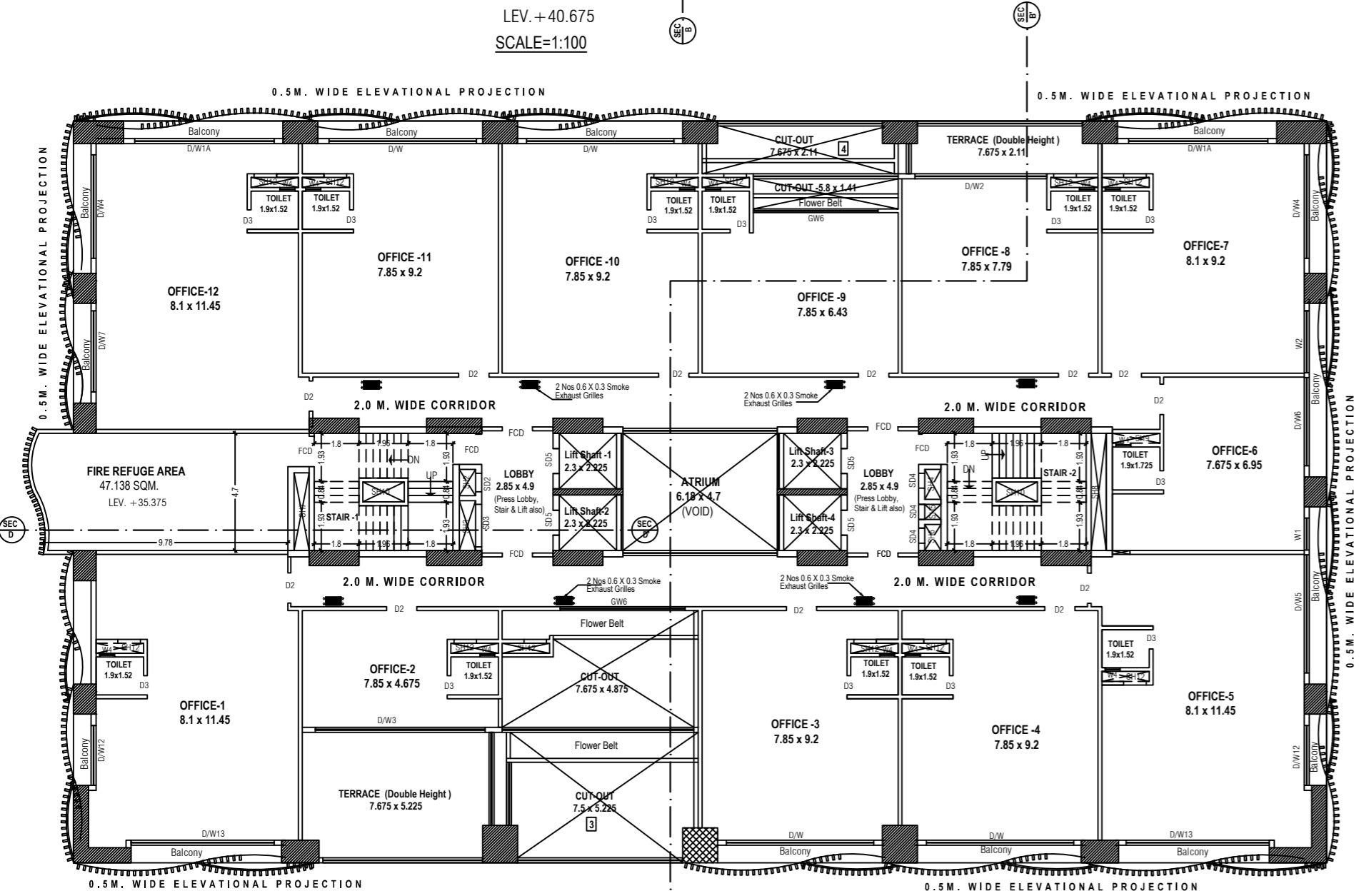
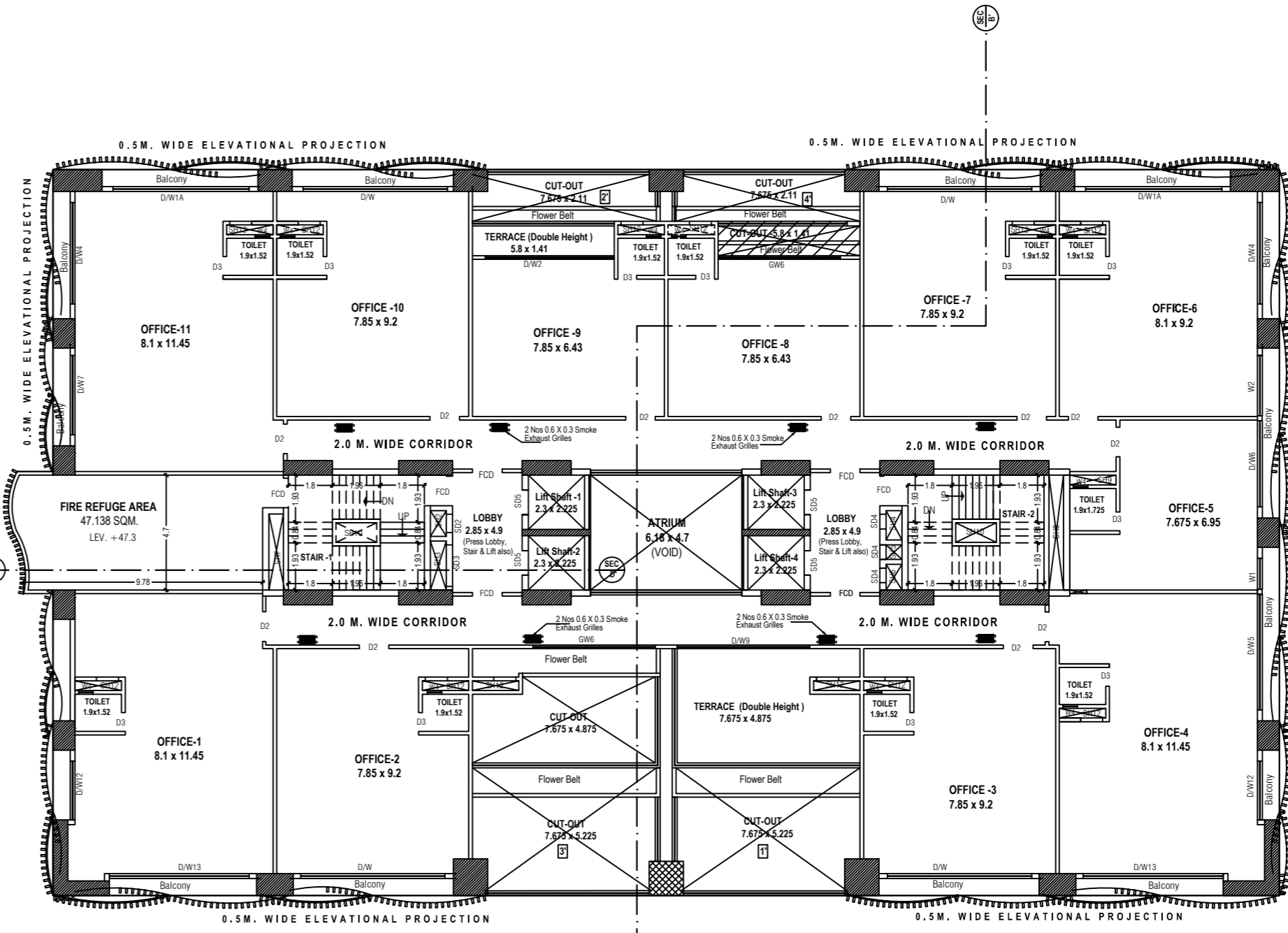
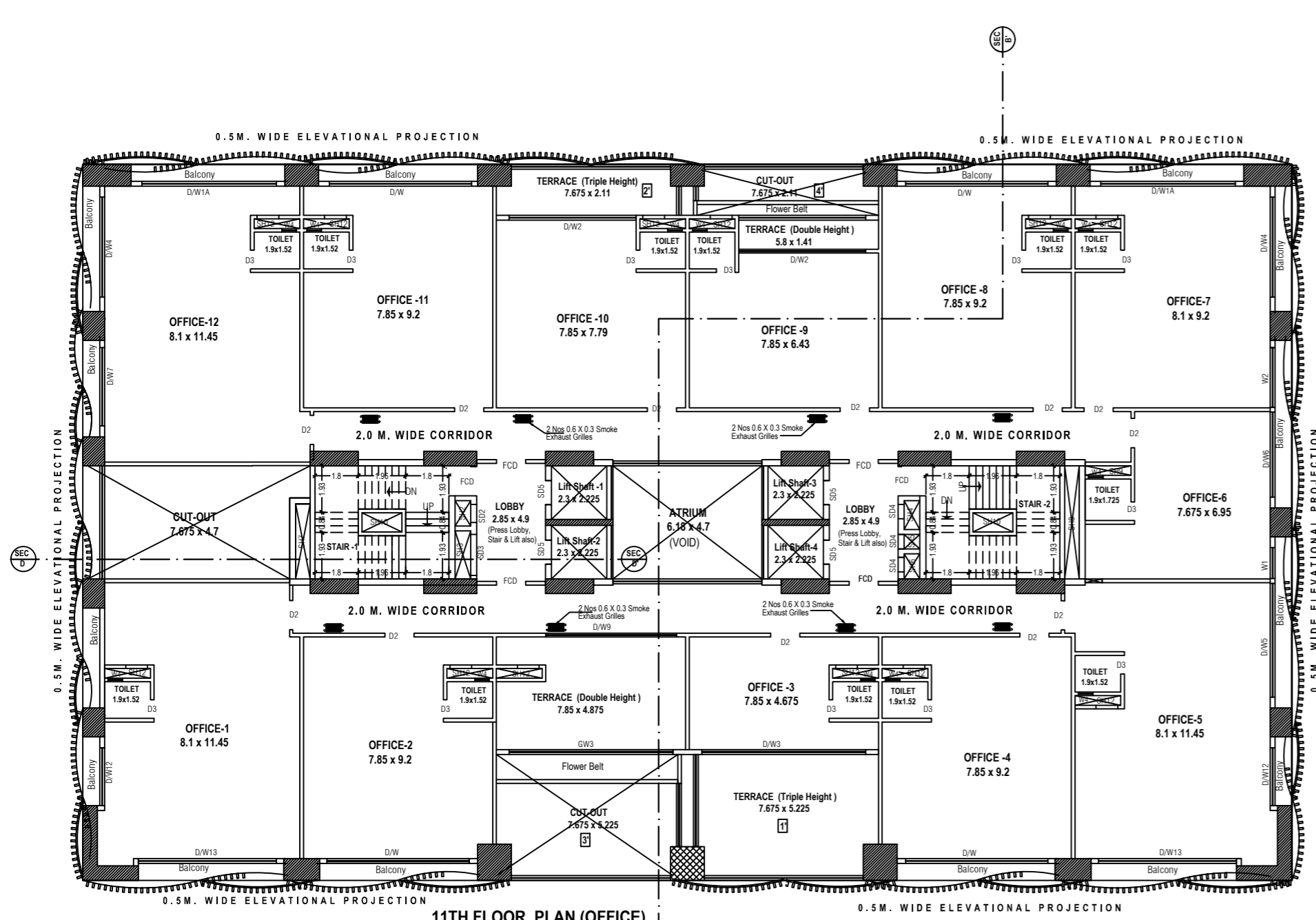

RESIDENT ARCHITECTS
D.J. CONSULTANTS & ASSOCIATES
295, DUMDUM PARK, KOL. - 55
PHONE NO.- 033-35548615
mail - info@djcam.org

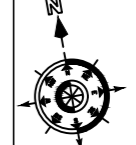

Space For Seal